

[January 2018 Latest SY0-501 Dumps PDF Free Download In Lead2pass 182q

Latest SY0-501 Dumps PDF Free Download In Lead2pass 100% SY0-501 Exam Pass Guaranteed:

<https://www.lead2pass.com/sy0-501.html> QUESTION 21 Drag and Drop Question A security administrator is given the security and availability profiles for servers that are being deployed. 1) Match each RAID type with the correct configuration and MINIMUM number of drives. 2) Review the server profiles and match them with the appropriate RAID type based on integrity, availability, I/O, storage requirements. Instructions: - All drive definitions can be dragged as many times as necessary - Not all placeholders may be filled in the RAID configuration boxes - If parity is required, please select the appropriate number of parity checkboxes - Server profiles may be dragged only once If at any time you would like to bring back the initial state of the simulation, please select the Reset button. When you have completed the simulation, please select the Done button to submit. Once the simulation is submitted, please select the Next button to continue.

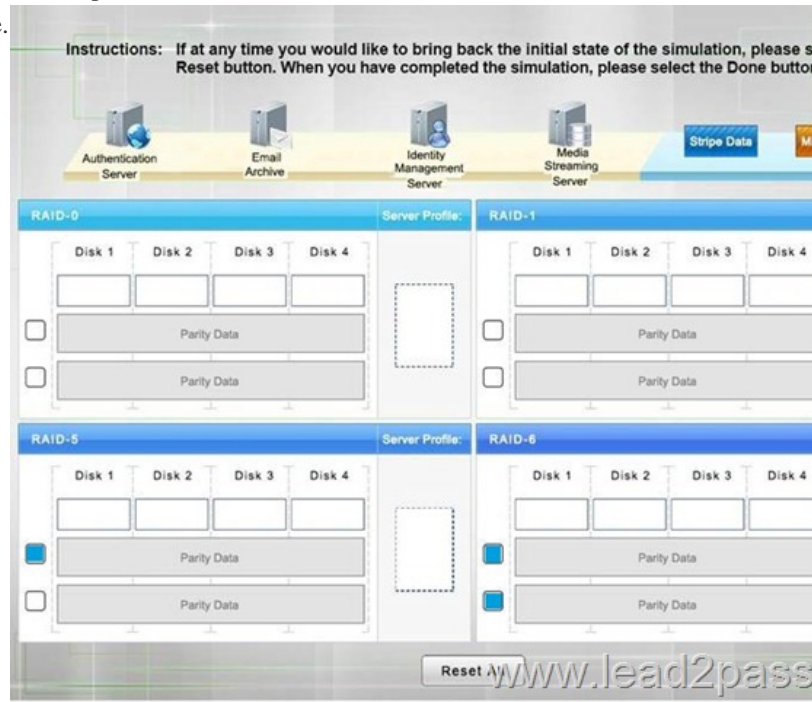

Answer:

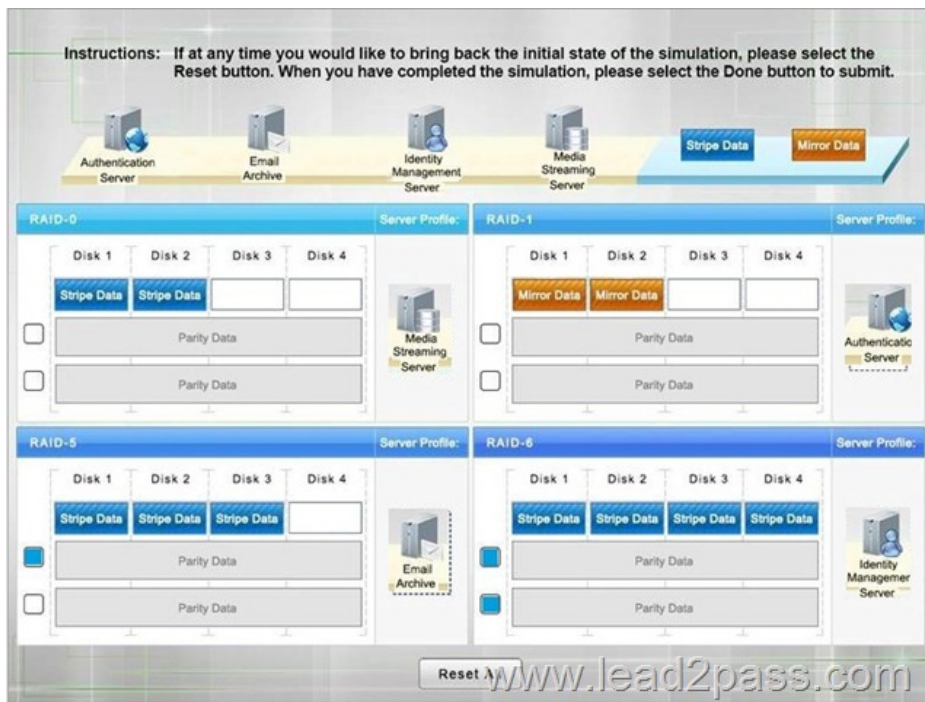

Explanation: RAID-0 is known as striping. It is not a fault tolerant solution but does improve disk performance for read/write operations. Striping requires a minimum of two disks and does not use parity. RAID-0 can be used where performance is required over fault tolerance, such as a media streaming server. RAID-1 is known as mirroring because the same data is written to two disks so that the two disks have identical data. This is a fault tolerant solution that halves the storage space. A minimum of two disks are used in mirroring and does not use parity. RAID-1 can be used where fault tolerance is required over performance, such as on an authentication server. RAID-5 is a fault tolerant solution that uses parity and striping. A minimum of three disks are required for RAID-5 with one disk's worth of space being used for parity information. However, the parity information is distributed across all the disks. RAID-5 can recover from a single disk failure. RAID-6 is a fault tolerant solution that uses dual parity and striping. A minimum of four disks are required for RAID-6. Dual parity allows RAID-6 to recover from the simultaneous failure of up to two disks. Critical data should be stored on a RAID-6 system. http://www.adaptec.com/en-us/solutions/raid_levels.html QUESTION 22

Refer to the following code:

```
public class rainbow {  
    public static void main (String [] args) {  
        object blue = null;  
        blue.hashCode (); }  
}
```

www.lead2pass.com

Which of the following vulnerabilities would occur if this is executed? A. Page exception B. Pointer dereference C. NullPointerException D. Missing null check Answer: D QUESTION 23 A database backup schedule consists of weekly full backups performed on Saturday at 12:00 A.m. and daily differential backups also performed at 12:00 A.m. If the database is restored on Tuesday afternoon, which of the following is the number of individual backups that would need to be applied to complete the database recovery? A. 1 B. 2 C. 3 D. 4 Answer: B QUESTION 24 Which of the following technologies employ the use of SAML? (Select TWO). A. Single sign-on B. Federation C. LDAP D. Secure token E. RADIUS Answer: AB QUESTION 25 An organization is using a tool to perform a source code review. Which of the following describes the case in which the tool incorrectly identifies the vulnerability? A. False negative B. True negative C. False positive D. True positive Answer: C QUESTION 26 In a corporation where compute utilization spikes several times a year, the Chief Information Officer (CIO) has requested a cost-effective architecture to handle the variable capacity demand. Which of the following characteristics BEST describes what the CIO has requested? A. Elasticity B. Scalability C. High availability D. Redundancy Answer: A QUESTION 27 A Security analyst is diagnosing an incident in which a system was compromised from an external IP address. The socket identified on the firewall was traced to 207.46.130.6666. Which of the following should the security analyst do to determine if the compromised system still has an active connection? A. tracer B. netstat C. Ping D. nslookup Answer: B QUESTION 28 Which of the following BEST describes an important security advantage yielded by implementing vendor diversity? A. Sustainability B. Homogeneity C. Resiliency D. Configurability Answer: C **SY0-501 dumps full version (PDF&VCE):** <https://www.lead2pass.com/sy0-501.html> **Large amount of free SY0-501 exam questions on Google Drive:** <https://drive.google.com/open?id=1Hm6GQHdV0sEnyhNf3EHqIGEt0r5IUfsfu> You may also need: SY0-401 exam dumps: <https://drive.google.com/open?id=0B3Syig5i8gpDLXZsWm9MWmh0a0E>